

KOOL MAX

Lavabo ovale con taglio obliquo e bordi con angoli a spigolo vivo, realizzato in VetroFreddo®.

Oval countertop washbasin with inclined cut and corners with sharp edges, produced in VetroFreddo®.

Articolo: Kool Max

Tipologia: Lavabo sopra piano

Materiale: VetroFreddo®

Troppo pieno: No

Peso: kg ±6,50

Article: kool Max

Category: Countertop washbasin

Material: VetroFreddo®

Overflow: No

Weight: kg ±6,50

COLORI COLOURS

white mat
KOOLMAXPO01



black mat
KOOLMAXPO30



cognac
KOOLMAXTO35



Ferrari red
KOOLMAXPL34



gold leaf 3d
KOOLMAXFO



mat dark inox / white mat
KOOLMAXDIPO01



old brass
KOOLMAXOB



old copper
KOOLMAXCPO



white gloss
KOOLMAXBL



moka mat
KOOLMAXPO33



red mat
KOOLMAXTO34



silver leaf 3d
KOOLMAXFA



copper leaf 3d
KOOLMAXFR



mat gold / white mat
KOOLMAXGDPO



old bronze
KOOLMAXBZO



old dark inox
KOOLMAXDXO

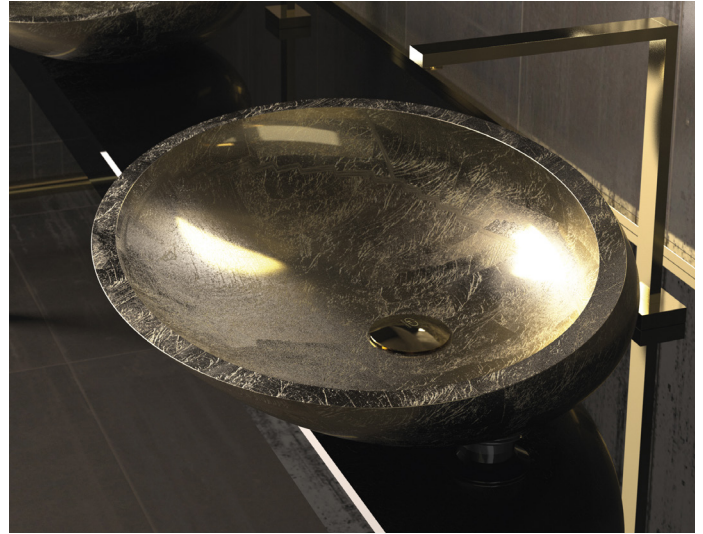

DATI TECNICI TECHNICAL DATA

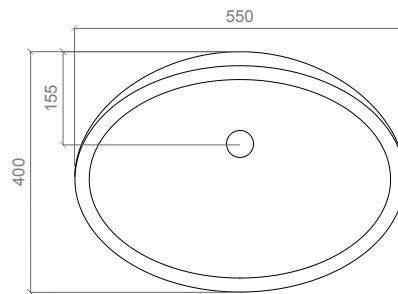
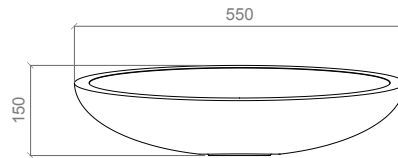
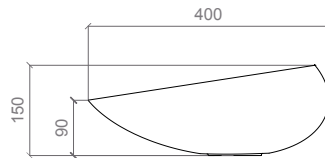

POSIZIONE RUBINETTERIA E LAVABO TAP AND SINK POSITIONING

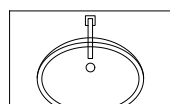
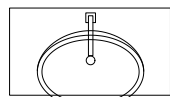
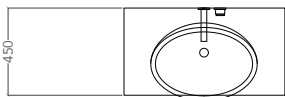
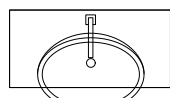
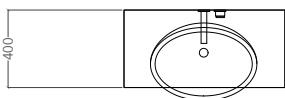

FORO SUL PIANO DI APPOGGIO HOLE ON THE TOP

foro antirotazione sotto lavabo M5
anti-rotation hole under washbasin M5

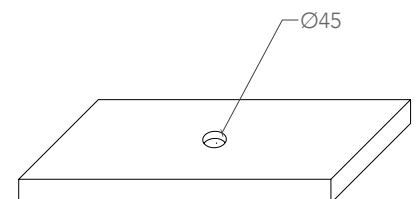

MATERIALE
MATERIAL

Il VetroFreddo è un materiale innovativo, composto da pigmenti vetrosi e resine. Uno dei suoi punti di forza è la possibilità di esprimersi in colori trasparenti, traslucidi e opachi. Ha una resistenza termica di 100°C e può essere lavorato con gli stessi utensili del marmo o del vetro.

VetroFreddo is an innovative material composed of glass pigments and resin. The material's unique characteristics are expressed through the way of its colour, which can be in transparent, semitransparent or opaque form, due to the material composition of glass pigments. VetroFreddo is temperature resistant up to approximately 100°C and can be worked with and carved just as marble or glass.

CURA E MANUTENZIONE
CARE AND MAINTENANCE

Si prega di pulire l'oggetto soltanto con acqua e sapone neutro, con l'ausilio di panni morbidi.

Non usare per alcun motivo soluzioni contenenti sostanze acide o abrasive e/o aggressive. Una pulizia non corretta potrebbe rovinare permanentemente la superficie; in tal caso l'azienda non potrà essere ritenuta in alcun modo responsabile.

Please clean the products with water and neutral soap only, using soft towels. Do not use for any reason cleaning solutions containing abrasive or aggressive substances. Incorrect cleaning may permanently ruin the surface of the products and in such case the company may not be held liable for damage.

ATOSSICITÀ
TOXICITY

Il prodotto non risulta tossico o nocivo all'uomo, agli animali e all'ambiente.

The product does not appear toxic to humans, animals or to the environment.

RIUTILIZZO
REUSE

Non disperdere l'oggetto nell'ambiente. Il prodotto può essere riutilizzato come oggetto decorativo per la casa.

Do not throw into the environment. The product could be reused as a decorative object for your home.